



CARVERS
SALES & LETTINGS

Elton Road
Darlington, DL3 8NB
Offers in the region of £350,000

Bungalow - Detached



Situated in the heart of the desirable West End of Darlington, this modern detached bungalow on Elton Road presents a rare opportunity and is sure to appeal to a wide range of buyers.

With its deceptively spacious layout, this property boasts three well-proportioned bedrooms, the master with a convenient dressing area and a separate w.c. off. There is also a family bathroom/w.c. with a separate shower cubicle. An entrance porch leading to a welcoming hallway, a well appointed living room and large fitted kitchen.

One of the standout features of this property is the generous driveway, providing off-road parking for several vehicles, along with a spacious garage that adds to the practicality of the home. The west-facing private rear garden is a delightful retreat, perfect for enjoying sunny afternoons. Additionally, the garden includes a useful hobby room or potting shed, catering to those with a passion for gardening or crafting.

Offered for sale with no onward chain, this larger style bungalow is a fantastic opportunity for anyone looking to settle in a peaceful yet accessible location. Don't miss your chance to make this lovely bungalow your new home.



- No onward chain
- West End location, walking distance to shops, schools etc.
- Three good sized bedrooms
- Driveway and garage
- Detached extended bungalow with handy utility room.
- Additional cloaks/wc
- Private west facing rear garden and conservatory
- Family bathroom with walk-in shower

GENERAL INFORMATION:

Tenure: Freehold

Services: Gas central heating, mains electric, water and drainage.

Double glazing

Local Authority: Darlington Borough Council (Tax Banding D)

Buyers Identification Checks

Should a purchaser(s) have an offer accepted on a property marketed by Carver Residential they will need to undertake an identification check. This is done to meet our obligation under Anti Money Laundering Regulations (AML) and is a legal requirement. We use a specialist third party service to verify your identity, this is not a credit check and will have no effect on credit history. The cost of these checks is £36 inc. VAT per buyer, which is paid in advance, when an offer is agreed and prior to a sales memorandum being issued. This charge is non-refundable.

Property Size

Please note the property size is taken from the Energy Performance Certificate and may not take into account all rooms from the floorplan (due to unheated space not being calculated e.g. this may potentially exclude a conservatory and/or garage)



Ground Floor
Approx. 138.8 sq. metres (1493.5 sq. feet)

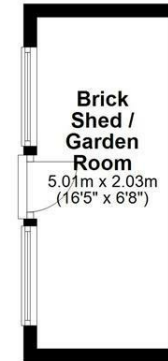
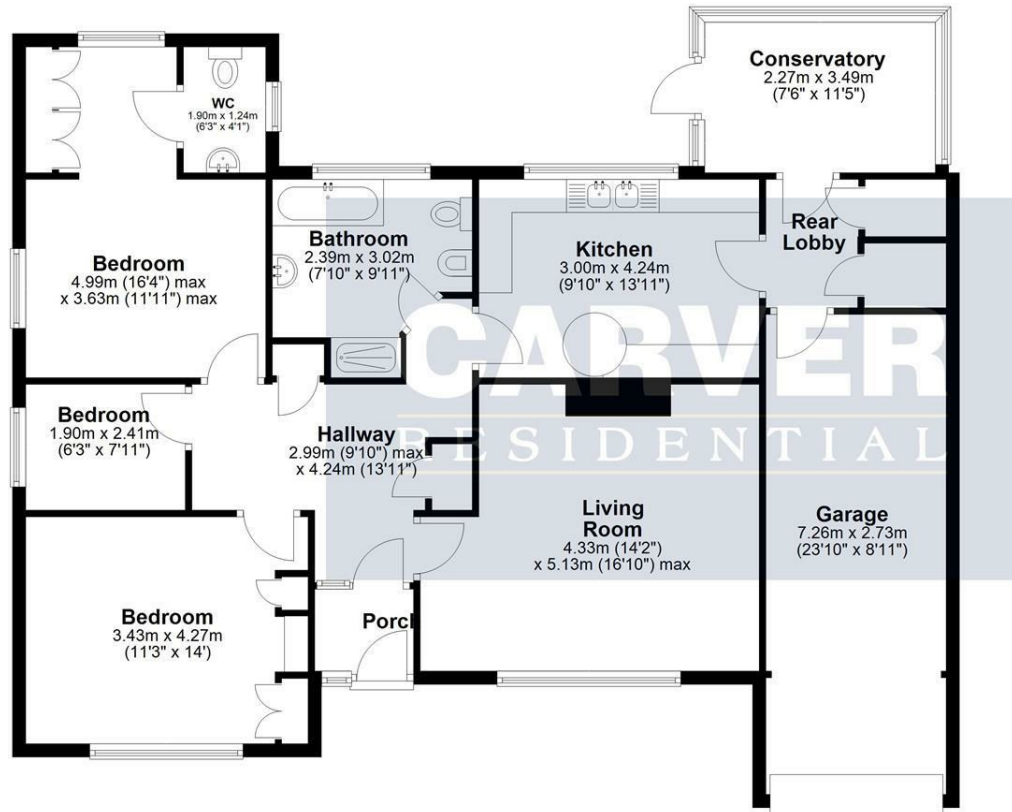

Energy Efficiency Rating		Current	Potential
Very energy efficient - lower running costs			
(92 plus) A			
(81-91) B			
(69-80) C			
(55-68) D		59	71
(39-54) E			
(21-38) F			
(1-20) G			
Not energy efficient - higher running costs			
England & Wales		EU Directive 2002/91/EC	

Property size taken from EPC
1054.00 sq ft

Total area: approx. 138.8 sq. metres (1493.5 sq. feet)
67 Elton Road, Darlington

Searching 1,000s of mortgages
Access to 12,000+ products from 90+ lenders across the UK.
Call: 01325 370341 Visit: Any of our offices
Web: mortgageadvicebureau.com/carvers

Your home may be repossessed if you do not keep up repayments on your mortgage.
There may be a fee for mortgage advice. The actual amount you pay will depend upon your circumstances.
The fee is up to 1% but a typical fee is 0.3% of the amount borrowed.

These particulars do not constitute any part of an offer or contract. None of the statements contained in these particulars are to be relied on as statements or representations of fact and any intending purchaser must satisfy themselves by inspection or otherwise to the correctness of each of the statements contained in these particulars. The vendor does not make or give, and neither Carvers nor any person in their employment has any authority to make or give any representation or warranty whatever in relation to this property.